



## Configured Oven Cabinet with Overlay Panel

Use One form for each Appliance

Dealership Name \_\_\_\_\_

Date \_\_\_\_\_

Designer Name \_\_\_\_\_

Phone \_\_\_\_\_

Project Name \_\_\_\_\_

Pricing Program Item # \_\_\_\_\_

Overlay Panels are manufactured with  $\frac{1}{16}$ " reveal on sides, and  $\frac{1}{8}$ " top and bottom (typical door clearances).

Left and Right dimensions of panel must be least  $1\frac{1}{16}$ ". Inside edge of cutout is NOT finished.

Overlay Panel opening is not completely cut through. Tabs hold center portion in place, and require field removal.  
Cabinet back of appliance opening may also require field cut-out.

### Use for **OCMWD** Oven Cabinets

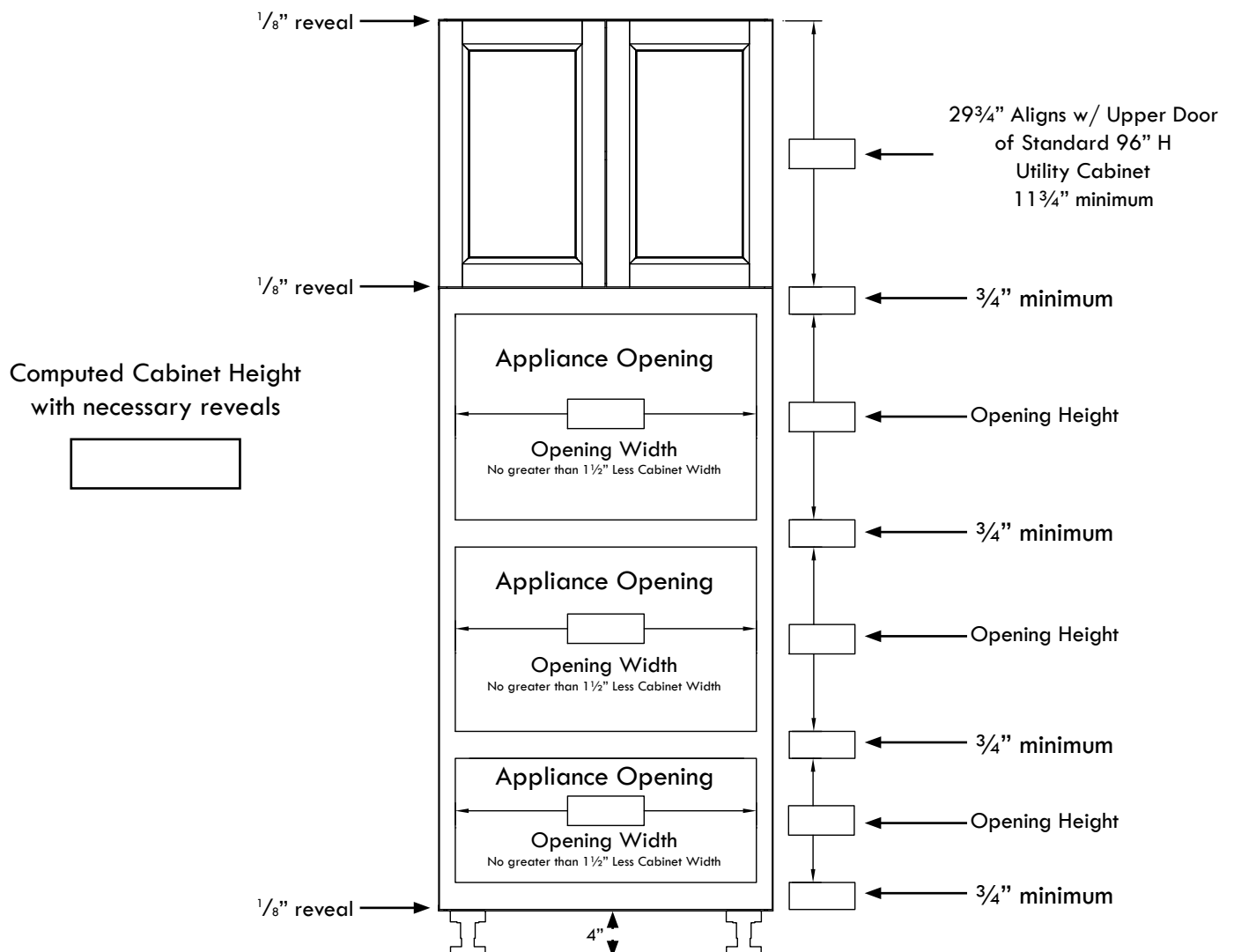

Email or Fax Form to:

customerservice@harmonikitchens.com • 972-227-5267